

PARALLEL PNEUMATIC GRIPPERS

PRECISION LOW PROFILE SERIES



RPLC Series
Starts at
\$285



**Clean Room
and Harsh
Environment**

- Precision Gripping—Preloaded V Roller Bearings Eliminate Side Play Resulting in Excellent Part Positioning
- Class 10 Clean Room Rated with Corrosion Resistant Shield, Clean Room Grade Lubricant and Scavenge Port
- Components Protected by Stainless Steel Shield for Use in Harsh Environments
- Accuracy of 0.05 mm (0.002") and Repeatability of 0.03 mm (0.001")
- Rigid and Low Friction Design Allows for Longer Finger lengths for Use on Delicate Parts
- Non-Synchronous Motion Option Provides Independent Jaw Operation
- Up to 5 Million Cycles in Typical Operation and 10 Million with Maintenance
- Operating Temperature -35 to 80°C (-30 to 180°F)
- System Requires 0.3 to 7 bar (5 to 100 psi) Dry Filtered (40 Micron or Better) Air Supply
- Requires 4-Way, 2 Position Valve and Regulator for Delicate Parts



RPLC-3M, \$522

DLT-10M-E-C-50,
\$270, visit
omegamation.com

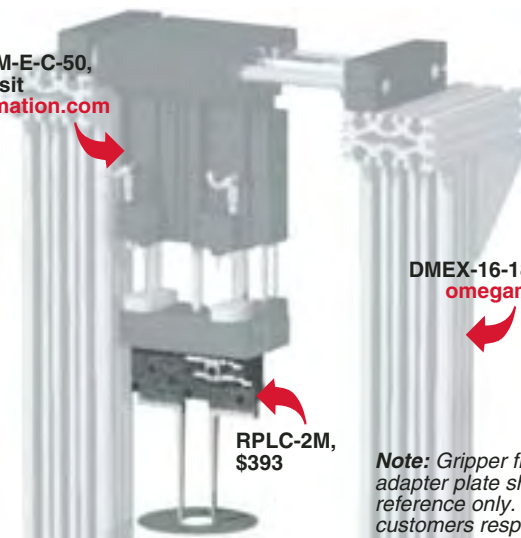

DMEX-16-18, \$72, visit
omegamation.com

RPLC-2M,
\$393

Note: Gripper fingers and adapter plate shown are for reference only. Tooling is customers responsibility.

PRODUCT FEATURES

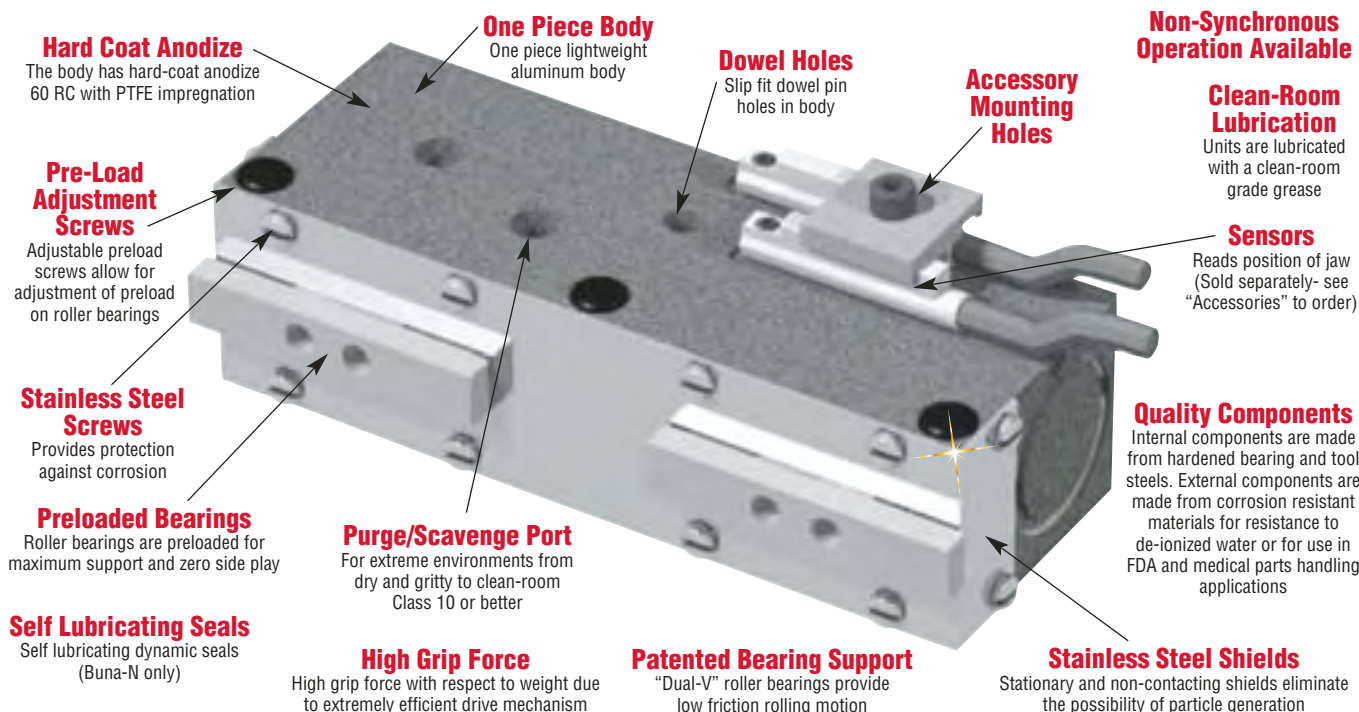



OPERATING PRINCIPLE

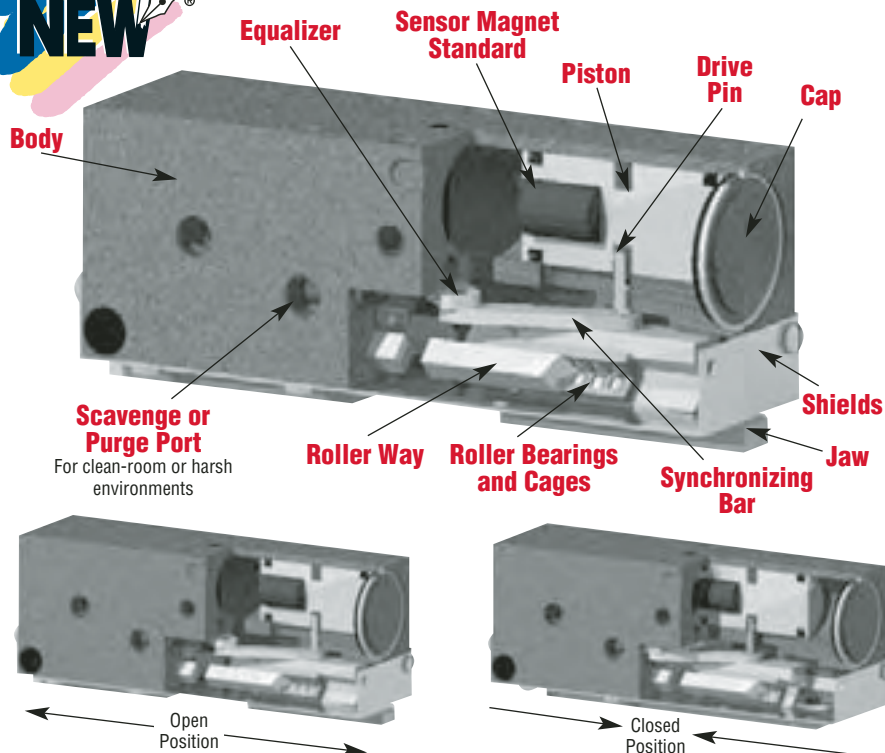

- Dual double acting opposed pistons, connected to both a jaw and a synchronizing bar by a drive pin, actuate in opposite directions.
- The synchronizing bars are connected to the equalizer which synchronizes the motion.
- The purge/scavenge port can be used to expel or retain contaminants using pressure or vacuum respectively.
- Suitable for internal or external gripping.
- The synchronizing elements can be removed for non-synchronous operation.

TECHNICAL SPECIFICATIONS

Pneumatic Specifications

Pressure Operating Range: 0.3 to 7 bar (5 to 100 psi)

Cylinder Type: Dual double acting

Dynamic Seals:

Internally lubricated Buna-N

Valve Required to Operate:

4-way, 2-position

Air Quality Requirements

Air Filtration: 40 micron or better

Air Lubrication: Not necessary*

Air Humidity: Low moisture content (dry)

Temperature Operating Range

Buna-N Seals (Standard): -35 to 80°C (-30 to 180°F)

FKM Seals (Optional): -30 to 120°C (-20 to 250°F)

Maintenance Specifications

Expected Life:

Normal Application: 5 million cycles

With Preventative Maintenance:

10+ million cycles*

Field Repairable: Yes

Seal Repair Kits Available: Yes

* Addition of lubrication will greatly increase service life.

MOUNTING INFORMATION

Grippers can be mounted and operated in any orientation.

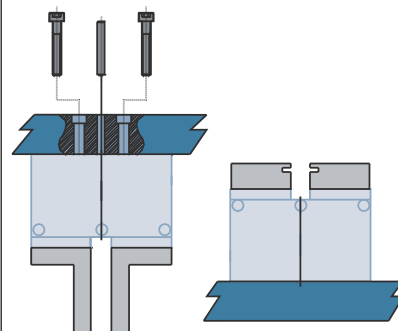

Body mounts with screws and locates with slip-fit dowel pins for accuracy.



Shields provide protection from falling debris when mounted upside down.

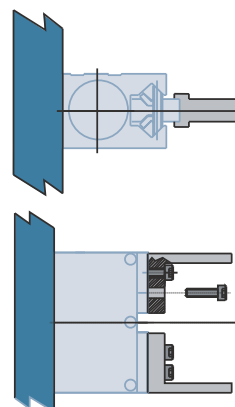

Fingers attach to jaws with screws and locate by keying

Dimensions: mm (in)

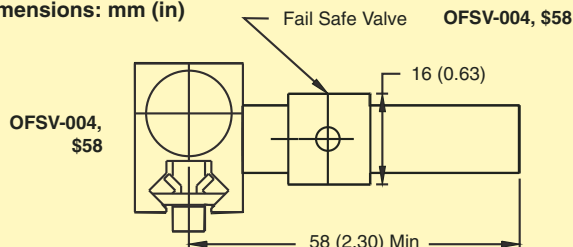

- Position Sensors Available—PNP or NPN Magneto Resistive Style, 2 per Gripper Recommended
- Sensors are Slot Mounted with Mounting Kit and Easily Adjusted with Hex Key

Magneto Resistive Sensor
OHSP-017, \$63 and
OHSN-017, \$63

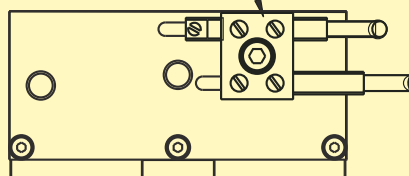

- Built-In LED for Ease of Positioning and Troubleshooting with Quick Disconnect Fitting
- Sensor Extension Cables Available in 2 or 5 m Long

PARALLEL PNEUMATIC GRIPPER— LOW PROFILE CLEAN ROOM SERIES RPLC-1M



RPLC-1M, \$285, shown
larger than actual size.



Dimensions: mm (in)

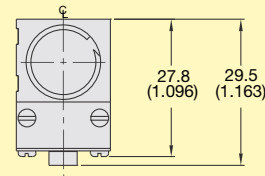
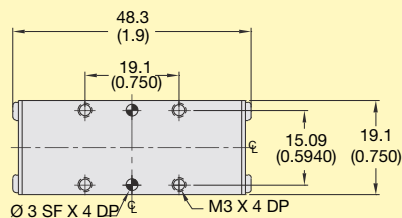
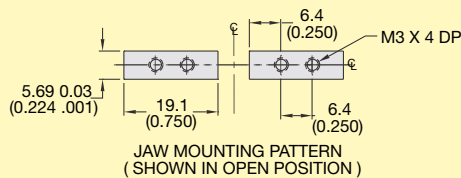
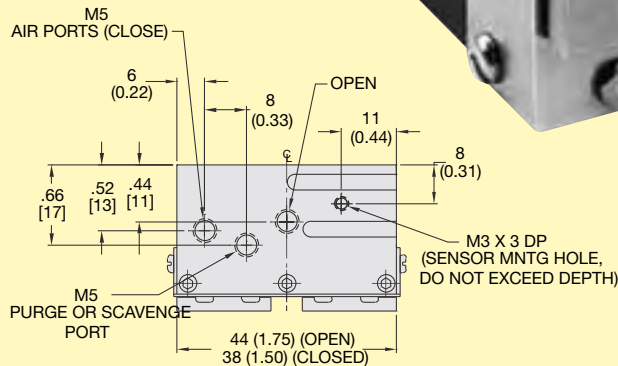

SPECIFICATIONS	RPLC-1M	RPLC-1
Total Rated Grip Force F @ 100 psi, 7 bar	116 N	26 lb
Stroke	6.4 mm	0.25"
Weight	0.07 Kg	0.16 lb
Pressure Range	0.3 to 7 bar	5 to 100 psi
Cylinder Bore Ø	11.1 mm	0.438"
Displacement	0.6 cm ³	0.038" ³
Temp Range (Standard Seals)	-35 to 80°C	-30 to 180°F
Temp Range (FKM Seals)	-30 to 120°C	-20 to 250°F
Actuation	0.10 sec	
Accuracy	±0.05 mm	±0.002"
Repeatability	±0.03 mm	±0.001"
Valve Required to Actuate	4-way, 2-position	

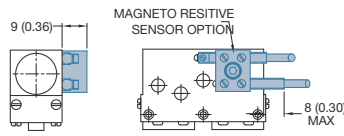
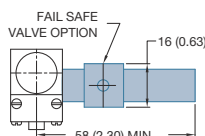
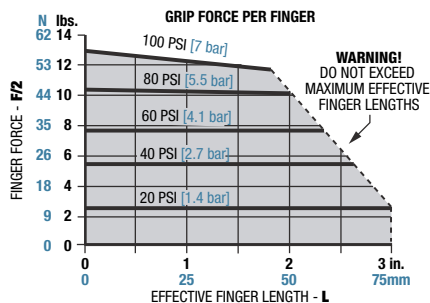

LOADING CAPACITY†	STATIC	DYNAMIC
Maximum Tensile T	222 N (50 lbs)	67 N (15 lbs)
Maximum Compressive C	222 N (50 lbs)	67 N (15 lbs)
Maximum Moment Mx	3.4 Nm (30"/lbs)	1.1 Nm (10"/lbs)
Maximum Moment My	4.5 Nm (40"/lbs)	1.4 Nm (12"/lbs)
Maximum Moment Mz	3.4 Nm (30"/lbs)	1.1 Nm (10"/lbs)

†Capacities are per set of jaws and are not simultaneous

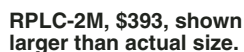

Dimensions: mm (in)

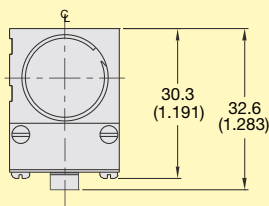

SPECIFICATIONS	RPLC-2M	RPLC-2
Total Rated Grip Force F @ 100 psi, 7 bar	116 N	26 lb
Stroke	12.7 mm	0.50"
Weight	0.09 Kg	0.20 lb
Pressure Range	0.3 to 7 bar	5 to 100 psi
Cylinder Bore Ø	11.1 mm	0.438"
Displacement	1.2 cm ³	0.075" ³
Temp Range (Standard Seals)	-35 to 80°C	-30 to 180°F
Temp Range (FKM Seals)	-30 to 120°C	-20 to 250°F
Actuation	0.13 sec	
Accuracy	±0.05 mm	±0.002"
Repeatability	±0.03 mm	±0.001"
Valve Required to Actuate	4-way, 2-position	

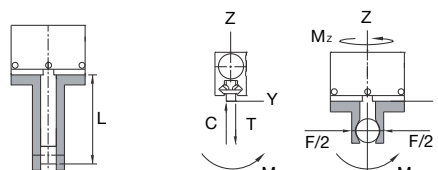
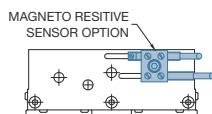
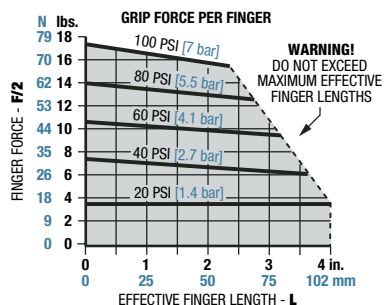

LOADING CAPACITY [†]	STATIC	DYNAMIC
Maximum Tensile T	289 N (65 lbs)	89 N (20 lbs)
Maximum Compressive C	289 N (65 lbs)	89 N (20 lbs)
Maximum Moment M_x	5.1 Nm (45"/lbs)	1.7 Nm (15"/lbs)
Maximum Moment M_y	6.8 Nm (60"/lbs)	2.3 Nm (20"/lbs)
Maximum Moment M_z	5.1 Nm (45"/lbs)	1.7 Nm (15"/lbs)

[†]Capacities are per set of jaws and are not simultaneous

PARALLEL PNEUMATIC GRIPPER— LOW PROFILE CLEAN ROOM SERIES RPLC-3M

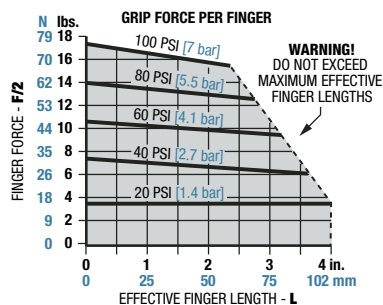
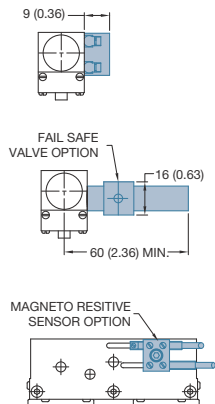
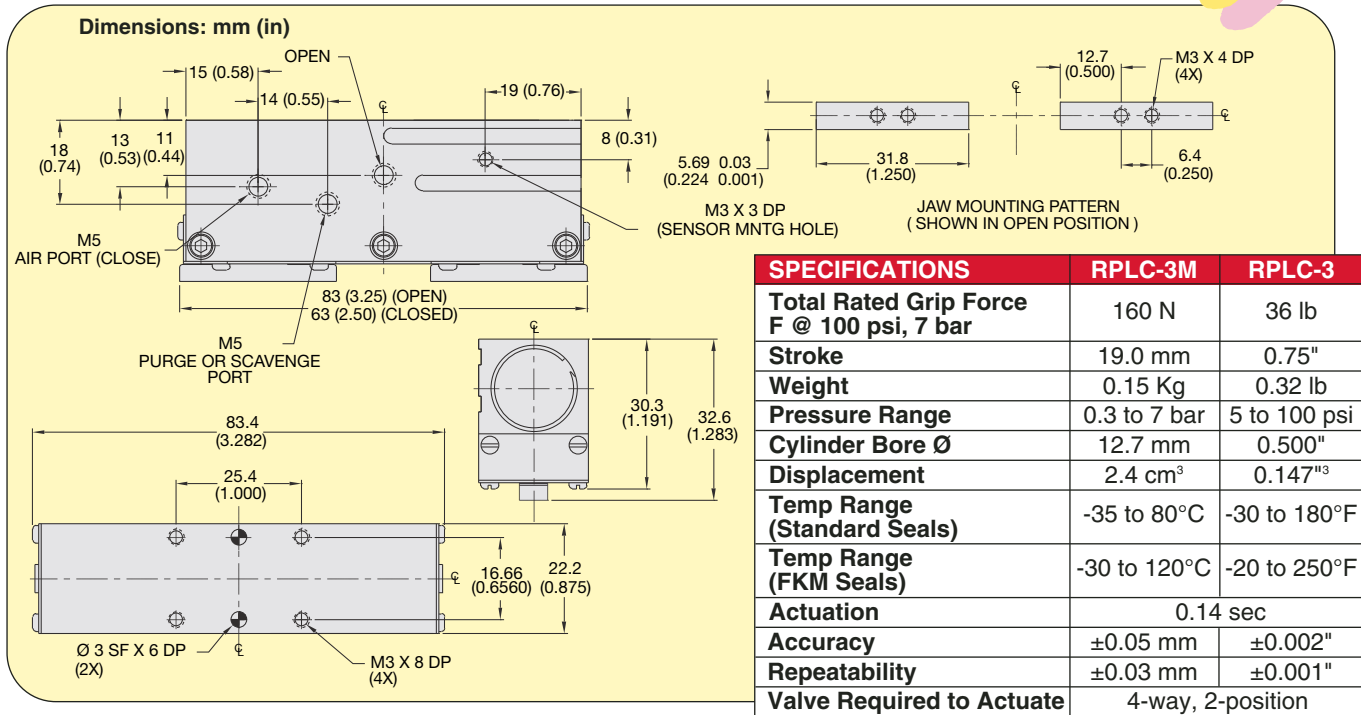

LOADING CAPACITY [†]	STATIC		DYNAMIC
	Static	Dynamic	
Maximum Tensile T	400 N (90 lbs)	133 N (30 lbs)	
Maximum Compressive C	400 N (90 lbs)	133 N (30 lbs)	
Maximum Moment M_x	6.8 Nm (60"/lbs)	2.3 Nm (20"/lbs)	
Maximum Moment M_y	9.0 Nm (80"/lbs)	2.8 Nm (25"/lbs)	
Maximum Moment M_z	6.8 Nm (60"/lbs)	2.3 Nm (20"/lbs)	

[†]Capacities are per set of jaws and are not simultaneous

To Order (Specify Model Number)

MODEL NO.	PRICE	BODY LENGTH mm (in)	BODY HEIGHT mm (in)	BODY DEPTH mm (in)	STROKE mm (in)	GRIP FORCE @ (lbs)	WEIGHT Kg (lbs)
RPLC-1M	\$285	48.3 (1.9)	29.5 (1.163)	19.1 (0.750)	6.4 (0.25)	116 (26)	0.07 (0.16)
RPLC-2M	393	62.9 (2.475)	29.5 (1.163)	19.1 (0.750)	12.7 (0.05)	116 (26)	0.09 (0.20)
RPLC-3M	522	83.4 (3.282)	32.6 (1.283)	22.2 (.875)	19.1 (0.75)	160 (36)	0.15 (0.32)

Ordering Example: RPLC-2M mini pneumatic low profile gripper with jaw stroke of 12.7 mm (0.05") **\$393**. Recommended accessories include 2 sensors and mounting kit, along with a 4-way, 2-position valve. Temperature rating of -35 to 80°C (-30 to 180°F). Temperature range can be extended to -30 to 120°C (-20 to 250°F) with FKM seals. Add "-V" to the end of the part number and **\$36**.

All models come with standard synchronous jaws, if non-synchronous jaws are required consult sales.

Detailed specification and CAD drawings are available at omegamation.com.

ACCESSORIES

MODEL NO.	PRICE	QTY/UNIT	DESCRIPTION
OSMK-008	\$15	1	Sensor mounting kit
OHSN-017	63	1 or 2	NPN magneto resistive sensor short barrel with quick disconnect fitting
OHSP-017	63	1 or 2	PNP magneto resistive sensor short barrel with quick disconnect fitting
CABL-010	23	1 or 2	2 m (6') sensor extension cable with quick disconnect fitting
CABL-013	26	1 or 2	5 m (16') sensor extension cable with quick disconnect fitting
OFSV-004	58	1	M5 fail safe valve

omega.co.uk®

Your One-Stop Source for Process Measurement and Control!

Freephone 0800 488 488 | International +44(0) 161 777 6622 | Fax +44(0) 161 777 6622 | Sales@omega.co.uk

www.omega.co.uk



UNITED STATES

www.omega.com

1-800-TC-OMEGA
Stamford, CT.

CANADA

www.omega.ca

Laval(Quebec)
1-800-TC-OMEGA

GERMANY

www.omega.de

Deckenpfronn, Germany
0800-8266342

UNITED KINGDOM

www.omega.co.uk

Manchester, England
0800-488-488
+44-(0)161-777-6611

FRANCE

www.omega.fr

0800-466-342

BENELUX

www.omega.nl

0800-099-33-44



More than 100,000 Products Available!

• Temperature

Calibrators, Connectors, General Test and Measurement Instruments, Handheld Instruments for Temperature Measurement, Ice Point References, Indicating Labels, Crayons, Cements and Lacquers, Infrared Temperature Measurement Instruments, Recorders, Relative Humidity Measurement Instruments, PT100 Probes, PT100 Elements, Temperature & Process Meters, Timers and Counters, Temperature and Process Controllers and Power Switching Devices, Thermistor Elements, Probes and Assemblies, Thermocouples, Thermowells and Head and Well Assemblies, Transmitters, Thermocouple Wire, RTD Probes

• Flow and Level

Air Velocity Indicators, Doppler Flowmeters, Level Measurement, Magnetic Flowmeters, Mass Flowmeters, Pitot Tubes, Pumps, Rotameters, Turbine and Paddle Wheel Flowmeters, Ultrasonic Flowmeters, Valves, Variable Area Flowmeters, Vortex Shedding Flowmeters

• pH and Conductivity

Conductivity Instrumentation, Dissolved Oxygen Instrumentation, Environmental Instrumentation, pH Electrodes and Instruments, Water and Soil Analysis Instrumentation

• Data Acquisition

Communication Products and Converters, Data Acquisition and Analysis Software, Data Loggers, Plug-in Cards, Signal Conditioners, USB, RS232, RS485, Ethernet and Parallel Port Data Acquisition Systems, Wireless Transmitters and Receivers

• Pressure, Strain and Force

Displacement Transducers, Dynamic Measurement Force Sensors, Instrumentation for Pressure and Strain Measurements, Load Cells, Pressure Gauges, Pressure Reference Section, Pressure Switches, Pressure Transducers, Proximity Transducers, Regulators, Pressure Transmitters, Strain Gauges, Torque Transducers, Valves

• Heaters

Band Heaters, Cartridge Heaters, Circulation Heaters, Comfort Heaters, Controllers, Meters and Switching Devices, Flexible Heaters, General Test and Measurement Instruments, Heater Hook-up Wire, Heating Cable Systems, Immersion Heaters, Process Air and Duct, Heaters, Radiant Heaters, Strip Heaters, Tubular Heaters